

Sunny-GII Plus



TATSUNO
FILLS UP YOUR *Happiness*



Sunny-GII
Plus

RELIABLE

JAPAN QUALITY DISPENSER



■ **BLUE LED DISPLAY** Long-lasting, A fine display uses-visibility bright blue LED back light.

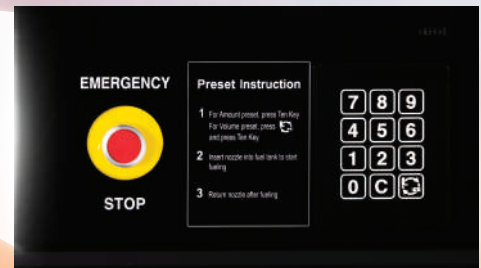

■ **WINDOW and DISPLAY**
Standard - equipped with user-friendly keypad.

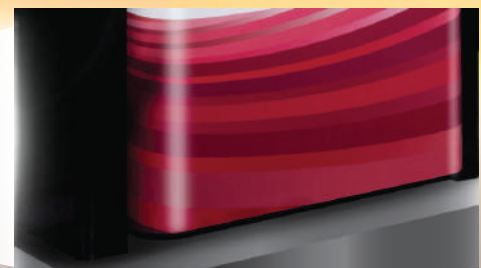

■ **NEW CURVED DESIGN**

SUPPORTED BY FULL RANGE OF OPTIONS

- Non-resettable electromagnetic totalizer
- Emergency stop switch ■ Sight glass
- Double swivel ■ Safety coupling
- Emergency shut-off valve (Shear valve) ■ Washable filter
- High-speed : 60 L/min Maximum speed : 80 L/min ■ Top gallery panel



GLOBAL STANDARD COMPONENTS

- Meet OIML standards and achieving optimum balance of excellent performance economically
- Compact body fits into narrow spaces

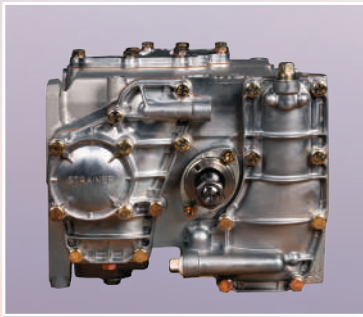

■ Gear Pump Type



■ 4-Piston flow meter



LIST OF FUNCTION AND MODELS

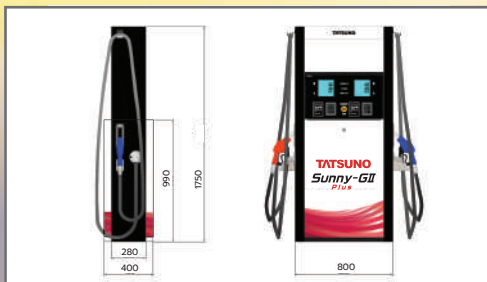

■ Dimension

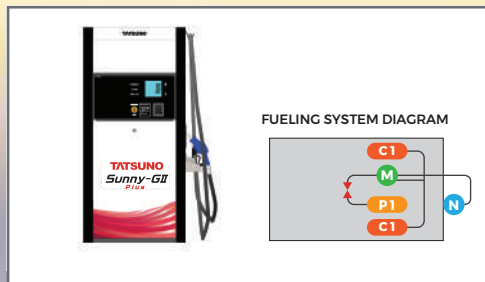

■ Type 1111

- P 1 pump
- N 1 nozzle
- C 1 counter
- M 1 simultaneous

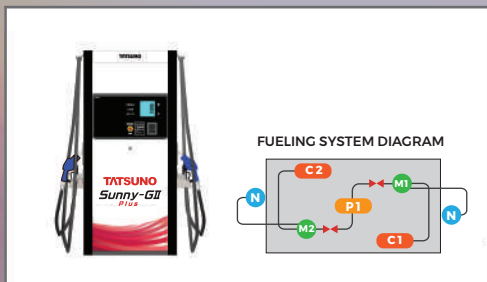

■ Type 1222

- 1 pump P
- 2 nozzle N
- 2 counter C
- 2 simultaneous M

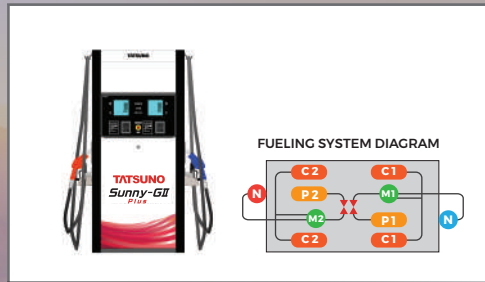

■ Type 2222

- P 2 pump
- N 2 nozzle
- C 2 counter
- M 2 simultaneous

GLOBAL STANDARD COMPONENTS

| <h2>Specifications</h2> | |
|------------------------------------|---|
| Delivery Speed | Standard speed (Gasoline/Diesel) : 40 - 45 L/min |
| | High speed (Gasoline/Diesel) : 50 - 60 L/min |
| | Max speed (Diesel) : 70 - 80 L/min |
| | Delivery speed is fluctuate by installed components (Suction type) |
| | Delivery speed is fluctuate by STD and installed components (Submersible type) |
| Suction Head (Suction Type) | 4 m (Gasoline column) / max 5 m (Diesel column) |
| Measuring Accuracy | ± 0.25% |
| Display Type | Micro-computer type electronic counter at non-hazardous area |
| Price and Volume Indication | Price : 7 digits 0.01 ! 99,999.99 |
| | Volume : 7 digits 0.01 ! 99,999.99 |
| | Unit price : 5 digits 0.01 ! 999.99 |
| | Decimal places are possible to change according to each local specification |
| Size of Display Character | Price readout : 30H x 120W mm |
| | Volume readout : 30H x 120W mm |
| | Unit price readout : 24H x 98W mm |
| Color of Display Character | Black characters with BLUE backlight. (LCD) |
| Reset Device | Automatic reset in nozzle holder |
| Totalizer | Electronic : 10 digits 99 999 999.99 liters (Displayed on counter) |
| Daily Totalizer | Electronic : 10 digits 99 999 999.99 liters (Displayed on counter) |
| Keypad | Volume and amount preset can be set up from dispenser. |
| | Numeric key only |
| Over Voltage Protector | Provided |
| Self-diagnosis | Provided |
| Initial-setting Method | By using keypad |
| Pulser | 0.01 L/pulse |
| Pump (Suction Type) | Internal silent gear pump with air separator, by-pass valves, suction strainer and check valves |
| Meter | 4-piston type positive displacement meter with electronic calibration |
| Flow Control Valve | 2-stage valve |
| Motor (Suction Type) | Explosion-proof, continuous duty motor with over-load protection |
| | 1-phase 3/4 HP (220 to 240 V) 1-phase 1 HP (220 to 240 V) 3-phase 1 HP (380 V) |
| Filter (Submersible Type) | Paper filter |
| Hose | 3/4" x 15 ft |
| Nozzle | 3/4" automatic stop nozzle |
| Swivel | Single swivel |

Note: The delivery speed of the pump may change due to the following condition if it is used beyond Tatsuno's installation and operational instructions:

1. Size and length of hose
2. Size and type of nozzle / swivel
3. Oil products, suction condition, and local piping condition

Specifications are subject to change with or without prior notice.



Website: www.tatsuno.co.th
 Line: salesbu
 Facebook: Tatsuno Thailand Co., Ltd.
 Tel: +66 2 532-0987, +66 2 532-7101-4, 061-386-4488, 061-393-8181
 Fax: +66 2 532-0986
TATSUNO (THAILAND) CO., LTD.
 1/8 Mu 3 Ladsawai Lamlukka
 Pathumthani, Thailand 12150